

NEW CONSTRUCTION FOR:

C & J PROPERTIES OF FISHKILL, LLC

MAIN STREET
FISHKILL, NY 12524
TAX MAP ID: 6155 - 08 - 924968
ZONING DISTRICT: VILLAGE CENTER BUSINESS DISTRICT (VC-BD),
HISTORIC PRESERVATION OVERLAY

DRAWING LIST		
SHEET NUMBER	SHEET NAME	CURRENT REVISION
A-1	ARCHITECTURE SITE PLAN	
A-2	FIRST FLOOR PLAN	

OFF-STREET PARKING SPACES				
USE	MIN. STANDARD	QUANTITY	REQUIRED	PROPOSED
MULTI-FAMILY DWELLING	1 FOR EACH DWELLING UNIT, PLUS 1/2 FOR EACH BEDROOM	4 UNITS, 8 BEDROOMS	8 SPACES	8 SPACES
RESTAURANT OR TAVERN	1 FOR EACH 2 SEATS	122 SEATS	61 SPACES	34 SPACES
		TOTAL	69 SPACES	42 SPACES

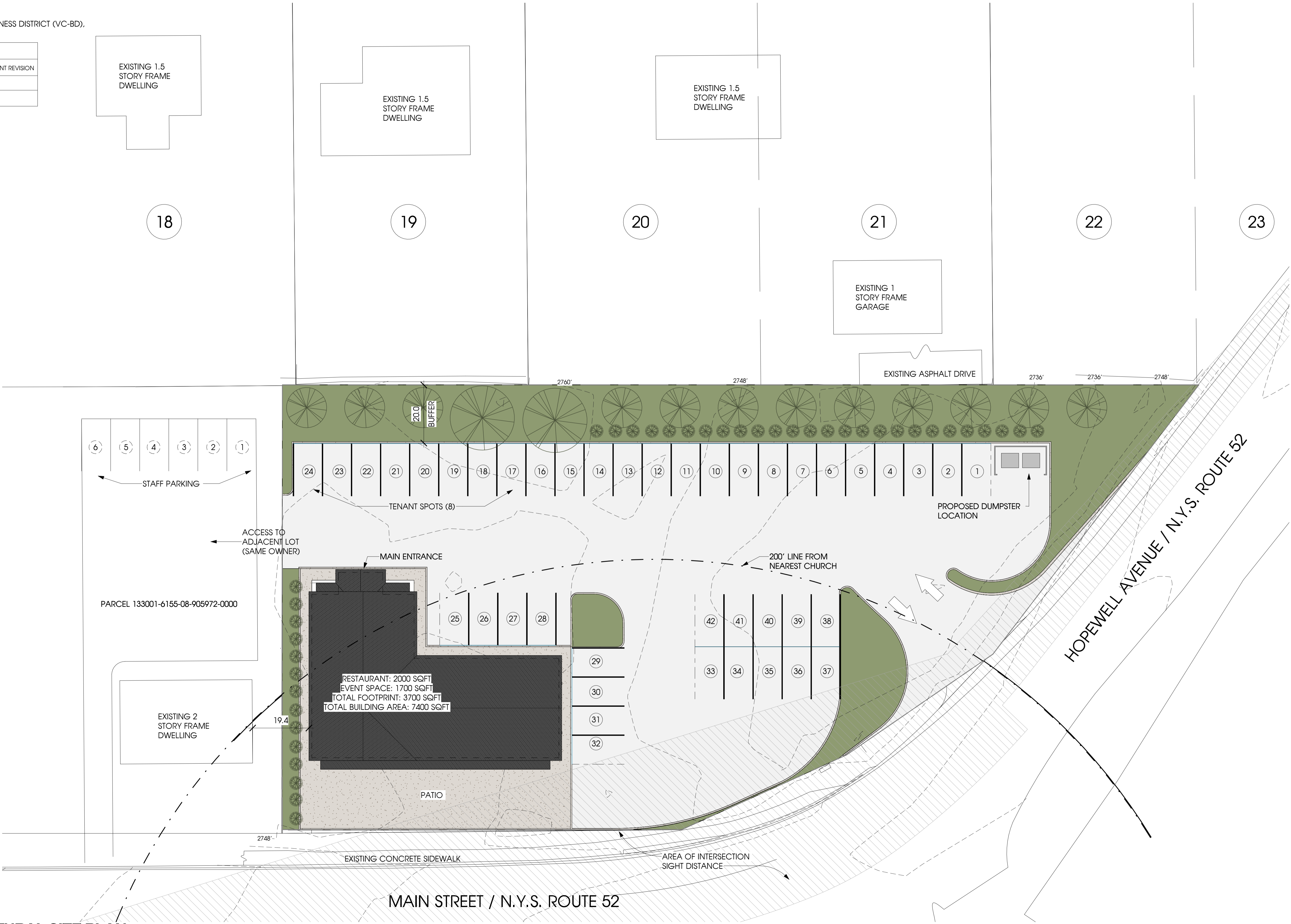

NOTE:
THE SITE PLAN INFORMATION PRESENTED
WAS TAKEN FROM A SURVEY PREPARED
BY "BADEY & WATSON, SURVEYING &
ENGINEERING, P.C." DATED JULY 2, 2025.
REFER TO ENGINEERING DRAWINGS FOR
CIVIL ENGINEERING DETAILS.



1 ARCHITECTURAL SITE PLAN
1/16" = 1'-0"

ARCHITECTURE
MASTER PLANNING
INTERIOR DESIGN



HUDSON
DESIGN

3052 ROUTE NINE
COLD SPRING, NY 10516

PHONE: 845-424-4810
FAX: 845-424-4815
www.hudsonsdesign.pro

NEW CONSTRUCTION FOR:

C & J PROPERTIES OF
FISHKILL, LLC

1183 MAIN STREET
FISHKILL, NY 12524

Proj. #24-006

UNDER NEW YORK STATE EDUCATIONAL LAW ARTICLE 145, § 69.5b, IT IS UNLAWFUL FOR ANY PERSON TO ALTER ANY ITEM ON THIS DRAWING, UNLESS ACTING UNDER THE DIRECTION OF A LICENSED PROFESSIONAL ARCHITECT. IF ANY ITEM IS ALTERED, THE ALTERING ARCHITECT SHALL AFFIX TO THE ITEM HIS SEAL AND THE NOTATION "ALTERED BY" FOLLOWED BY HIS SIGNATURE AND THE DATE OF SUCH ALTERATION AND A SPECIFIC DESCRIPTION OF THE ALTERATION. THIS DRAWING, AS AN INSTRUMENT OF SERVICE, IS AND SHALL REMAIN THE PROPERTY OF THE ARCHITECT. THIS DRAWING SHALL NOT BE REPRODUCED, PUBLISHED, USED ON OTHER PROJECTS, USED FOR ADDITIONS TO THIS PROJECT OR USED FOR COMPLETION OF THIS PROJECT BY OTHERS, EXCEPT BY AGREEMENT IN WRITING. COPYRIGHT © 2024, HUDSON DESIGN ARCHITECTURE & CONSTRUCTION MANAGEMENT LLC

ISSUED FOR PLANNING
BOARD

7 AUGUST 2025

ARCHITECTURAL
SITE PLAN

A-1

Proj. #24-006
C & J PROPERTIES OF FISHKILL, LLC



1 PROPOSED EAST ELEVATION - FACING PARKING LOT
1/4" = 1'-0"



2 PROPOSED SOUTH ELEVATION - FACING RT 52
1/4" = 1'-0"

ARCHITECTURE
MASTER PLANNING
INTERIOR DESIGN



HUDSON
DESIGN

3052 ROUTE NINE
COLD SPRING, NY 10516

PHONE: 845-424-4810
FAX: 845-424-4815
www.hudsonsdesign.pro

NEW CONSTRUCTION FOR:

C & J PROPERTIES OF
FISHKILL, LLC

1183 MAIN STREET
FISHKILL, NY 12524

Proj. #24-006

UNDER NEW YORK STATE EDUCATIONAL LAW ARTICLE 145, § 69.5b, IT IS UNLAWFUL FOR ANY PERSON TO ALTER ANY ITEM ON THIS DRAWING, UNLESS ACTING AS A PROFESSIONAL ARCHITECT. IF ANY ITEM IS ALTERED, THE ALTERING ARCHITECT SHALL AFFIX TO THE ITEM HIS SEAL AND THE NOTATION "ALTERED BY" FOLLOWED BY HIS SIGNATURE AND THE DATE OF SUCH ALTERATION AND A SPECIFIC DESCRIPTION OF THE ALTERATION. THIS DRAWING, AS AN INSTRUMENT OF SERVICE, IS AND SHALL REMAIN THE PROPERTY OF THE ARCHITECT. THIS DRAWING SHALL NOT BE REPRODUCED, PUBLISHED, USED ON OTHER PROJECTS, USED FOR ADDITIONS TO THIS PROJECT, OR USED FOR COMPLETION OF THIS PROJECT BY OTHERS, EXCEPT BY AGREEMENT IN WRITING. COPYRIGHT © 2024, HUDSON DESIGN ARCHITECTURE & CONSTRUCTION MANAGEMENT LLC

ISSUED FOR PLANNING
BOARD

7 AUGUST 2025

EXTERIOR
ELEVATIONS

A-2

Proj. #24-006
C & J PROPERTIES OF FISHKILL, LLC